

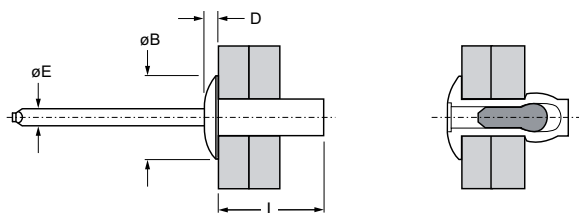





| English | Français | Deutsch | Italiano | Español |
|-----------------------------------|---|------------------------------|---|---|
| Dome head | Tête plate | Flachrundkopf | Testa Tonda | Cabeza alomada |
| Body: Copper* Natural | Corps: Cuivre* Brut | Hülse: Kupfer* Blank | Corpo: Rame* Nessuna finitura | Cuerpo: Cobre* Natural |
| Stem: Steel Protective coating | Tige: Acier Revêtement de protection | Dorn: Stahl Schutzüberzug | Gambo: Acciaio Rivestimento protettivo | Vástago: Acero Revestimiento preservador |

*: 110

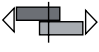

| Ø |  | |  | | L | ØE | ØB | D |  |  | Part No. |
|---------------|--|---------------|--|----------------|----------------|---------------|---------------|---------------|--|--|----------|
| nom. | min. | max. | min. | max. | ref. | ref. | max. | max. | lbf (kN) ¹⁾ | lbf (kN) ¹⁾ | |
| 1/8" (3.2) | .126 (3.2) | .187 (4.8) | .129 (3.28) | .133 (3.38) | .362 (9.2) | .064 (1.6) | .248 (6.3) | .051 (1.3) | 270 (1.20) | 335 (1.49) | CD 43 H |
| | .188 (4.8) | .250 (6.4) | | | .425 (10.8) | | | | | | CD 44 H |
| | .251 (6.4) | .312 (7.9) | | | .487 (12.4) | | | | | | CD 45 H |

dimensions in inches and (mm) / en pouces et (millimètre) / alle Maße in Zoll und (mm) / in pollici e (millimetri) / en pulgadas y (milímetros)

1) typical values / valeurs moyennes / typische Werte / Valori tipici / valores típicos